

STUDIO 3

60 ft L × 60 ft W × 24 ft H

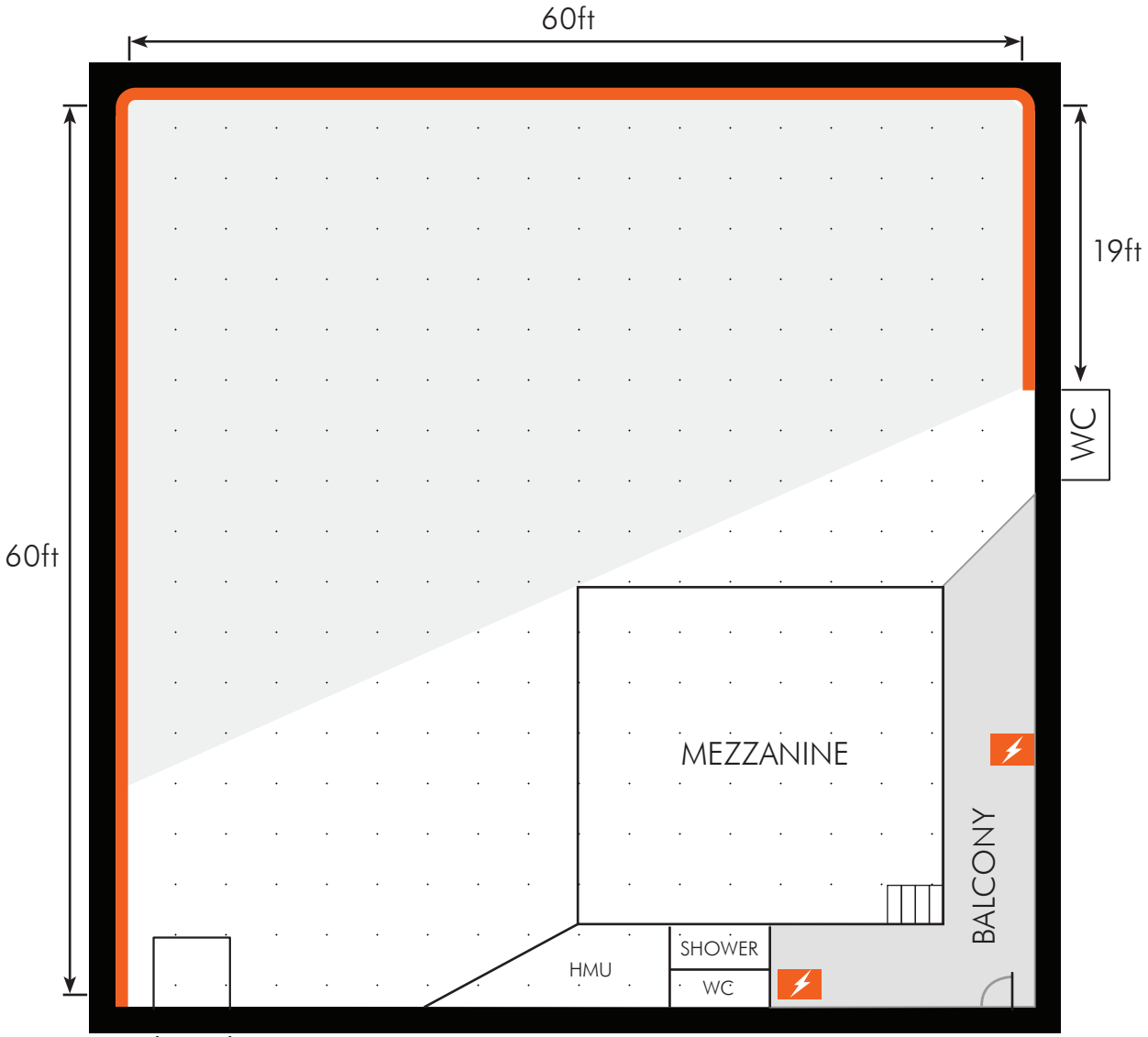

A series of horizontal dotted lines for notes or additional information.

ACCESS

5.5ft W x 6.5ft H

⚡ POWER

STUDIO 3 RIG

60 ft L × 60 ft W × 24 ft H

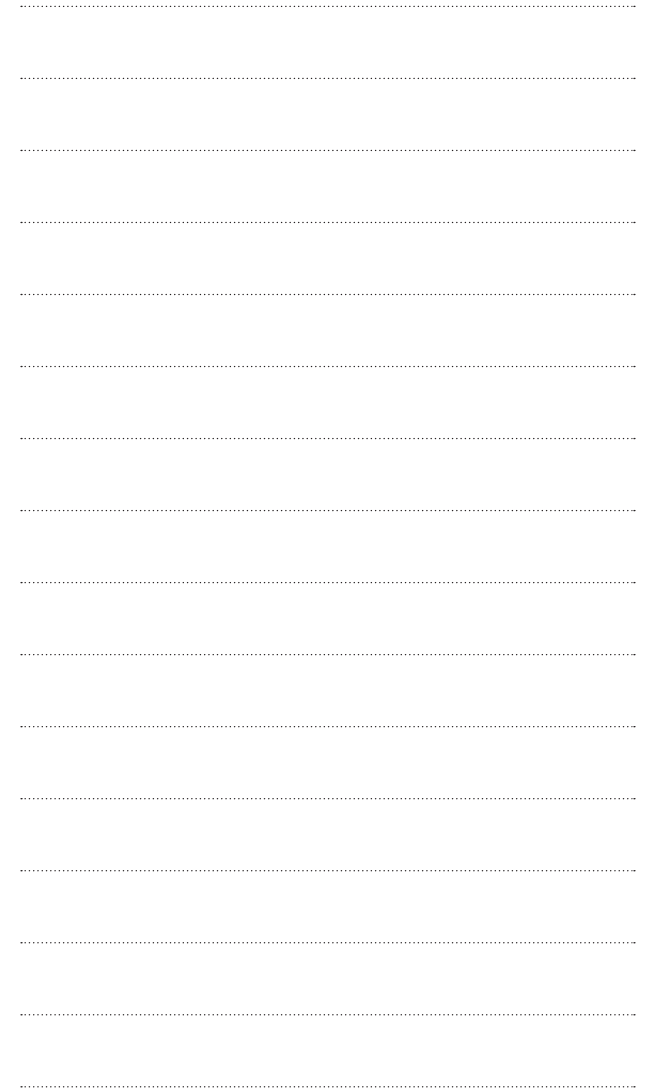
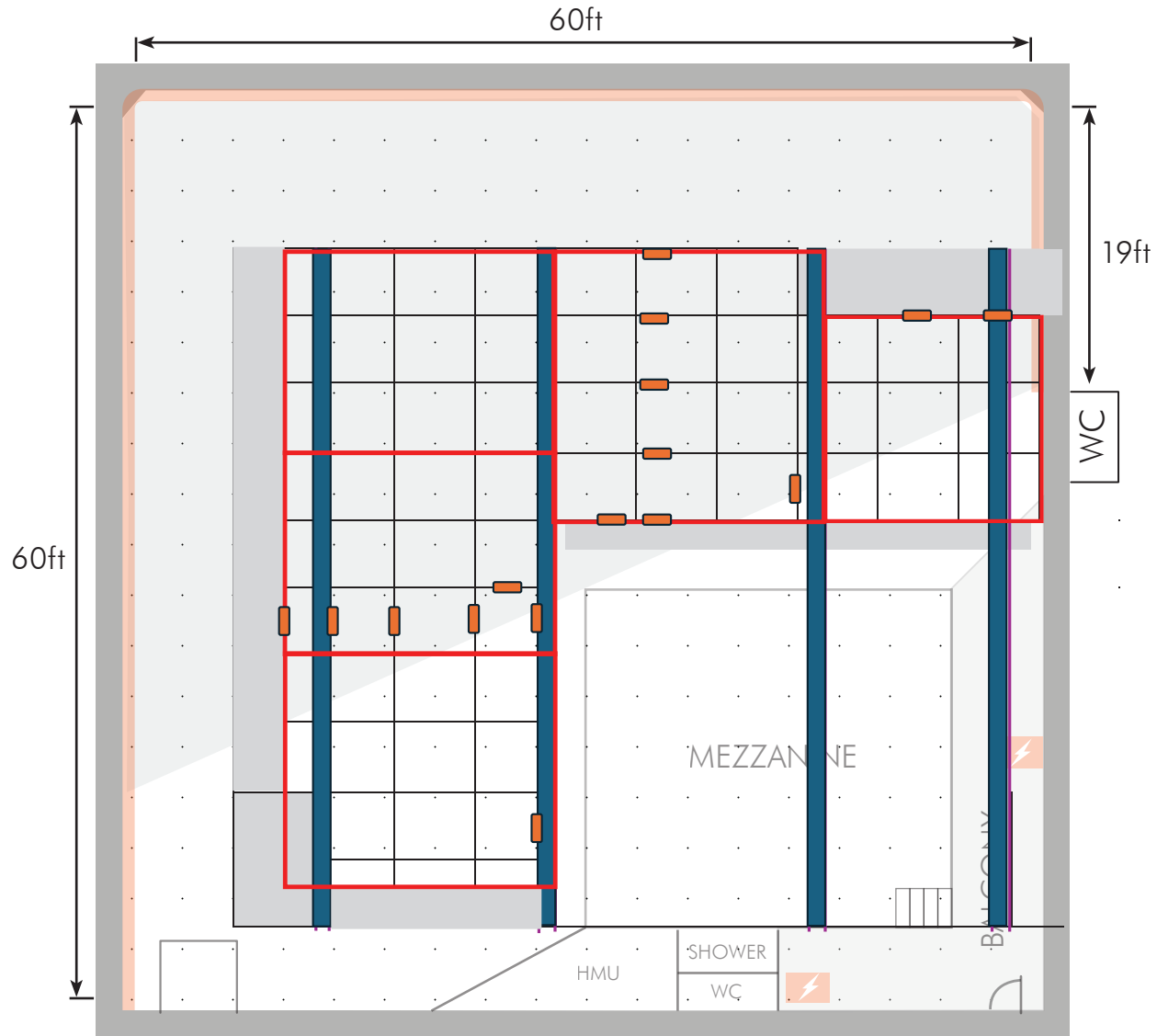

- ACCESS 5.5ft W x 6.5ft H
- SCAFFOLD SPLICING
- STRUCTURAL BEAMS
- 1000KG LOAD AREA
- UNAVAILABLE AREA
- POWER